

Lat 35d 00.000 m

TRAIL MAP - WALLS OF JERICO

Lat 35d 00.000 m

Lon -86d 07.000 m

Lon -86d 06.000 m

Lon -86d 05.000 m

Lon -86d 04.000 m

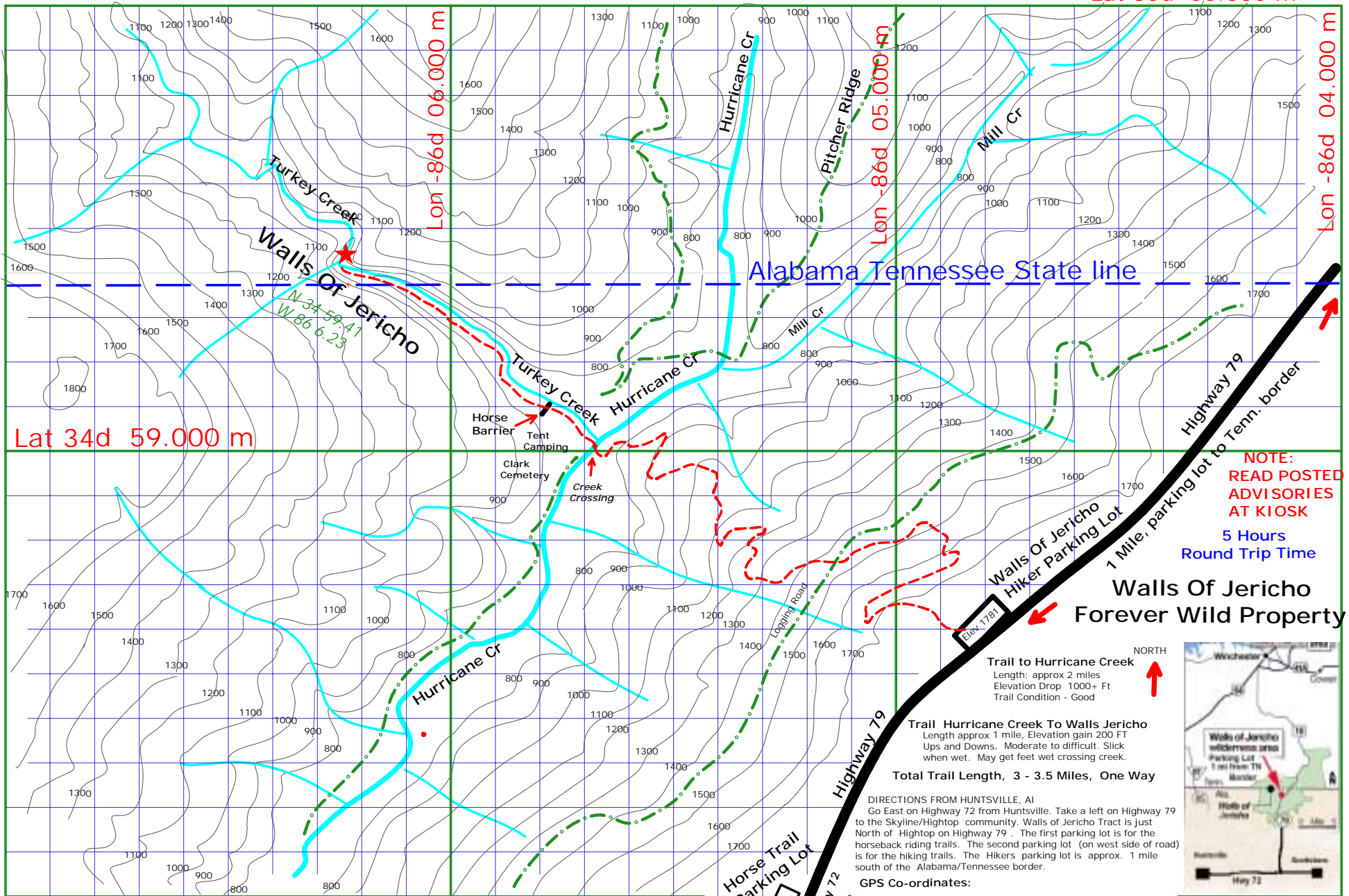

Lat 34d 59.000 m

Lat 34d 58.000 m

yblitz5@briartech.com
 N. Walker yblitz5@briartech.com 10/18/2004
 See www.briartech.com for current email address
 corrections/suggestions appreciated

Alabama Tennessee State line

**NOTE:
 READ POSTED
 ADVISORIES
 AT KIOSK**

5 Hours Round Trip Time

**Walls Of Jericho
 Forever Wild Property**

Trail to Hurricane Creek
 Length: approx 2 miles
 Elevation Drop 1000+ Ft
 Trail Condition - Good

Trail Hurricane Creek To Walls Jericho
 Length approx 1 mile, Elevation gain 200 FT
 Ups and Downs, Moderate to difficult. Slick when wet. May get feet wet crossing creek.

Total Trail Length, 3 - 3.5 Miles, One Way

DIRECTIONS FROM HUNTSVILLE, AL
 Go East on Highway 72 from Huntsville. Take a left on Highway 79 to the Skyline/Hightop community. Walls of Jericho Tract is just North of Hightop on Highway 79. The first parking lot is for the horseback riding trails. The second parking lot (on west side of road) is for the hiking trails. The Hikers parking lot is approx. 1 mile south of the Alabama/Tennessee border.

GPS Co-ordinates:
 Hiker Parking Lot : N 34 58.62, W 86 4.82
 Hurricane Cr/Trail : N 34 59.01, W 86 5.68
 Walls Of Jericho : N 34 59.41, W 86 6.23

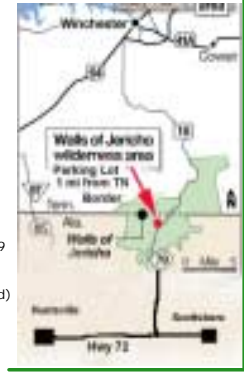

Hwy 79/Tn Border:
 N 34 59.38, W 86 4.04

Horse Trail Parking Lot
 To Hwy 72

Walls Of Jericho Hiker Parking Lot
 1 Mile, parking lot to Tenn. border

Highway 79

Filey 1781

