

Lon -86d 06.0'

ACCESS MAP

BUCK'S POCKET

MORGAN'S COVE

HIGH FALLS

From Guntersville, take Highway 227 East
Follow 227 past Guntersville State Park
Hwy 227 turns to right (east) at big intersection.
Follow 227 east and then southeast
Watch for signs and take county roads
for Morgan's Cove, Buck's Pocket Park
and High Falls

Use Trail Map for Buck's Pocket for details of Trails
yblitz5@briartech.com
yblitz@briartech.com (Norm Walker)
2/26/02

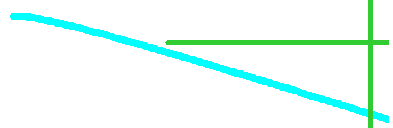
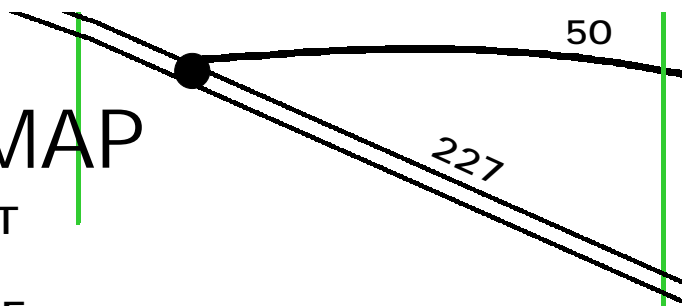

Lat 34d 25.0'

Lon -86d 04.0'

Town Creek

Lat 34d 24.0'

High Fa

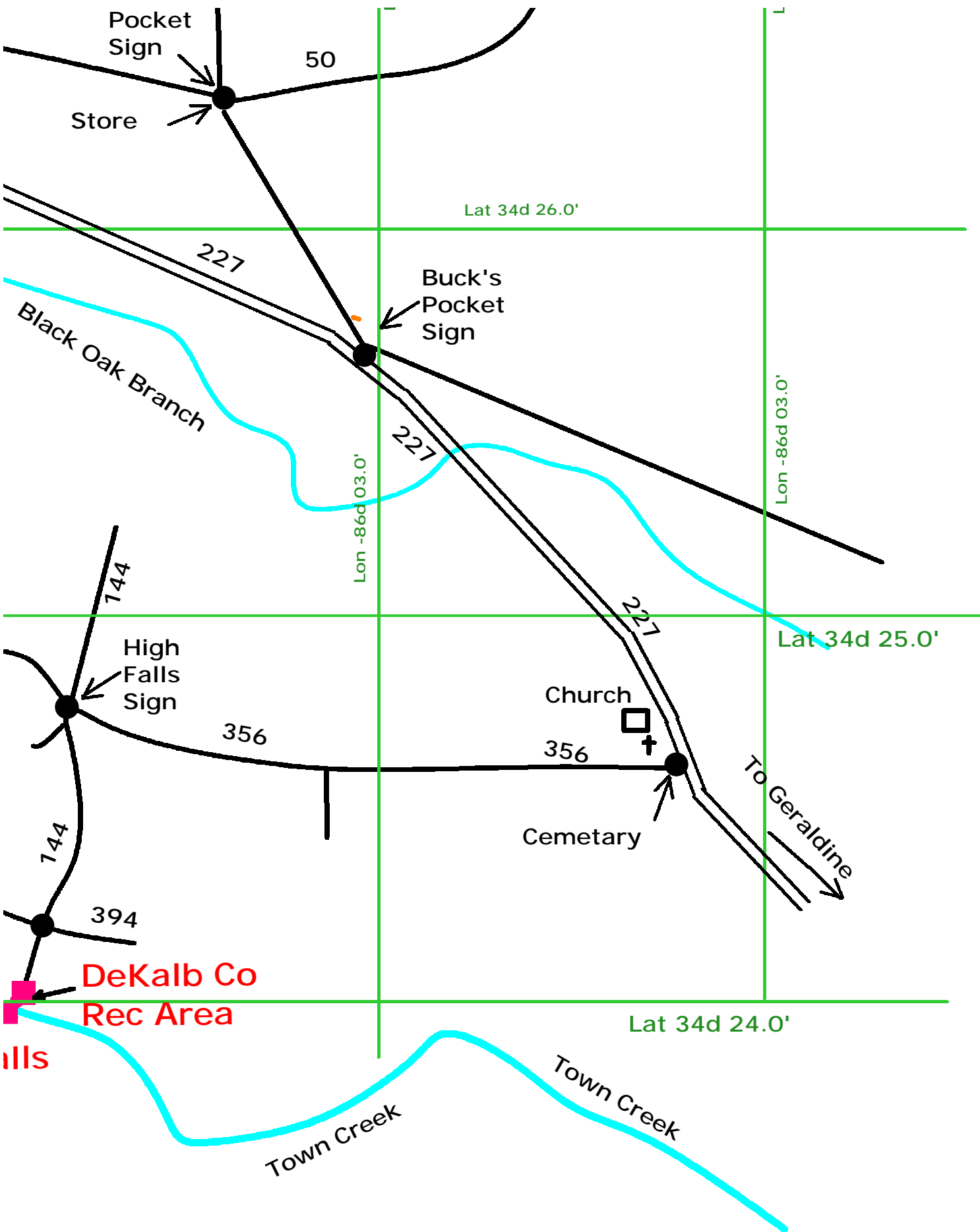

DeKalb Co
Rec Area

ills

Town Creek

Town Creek

To Geraldine

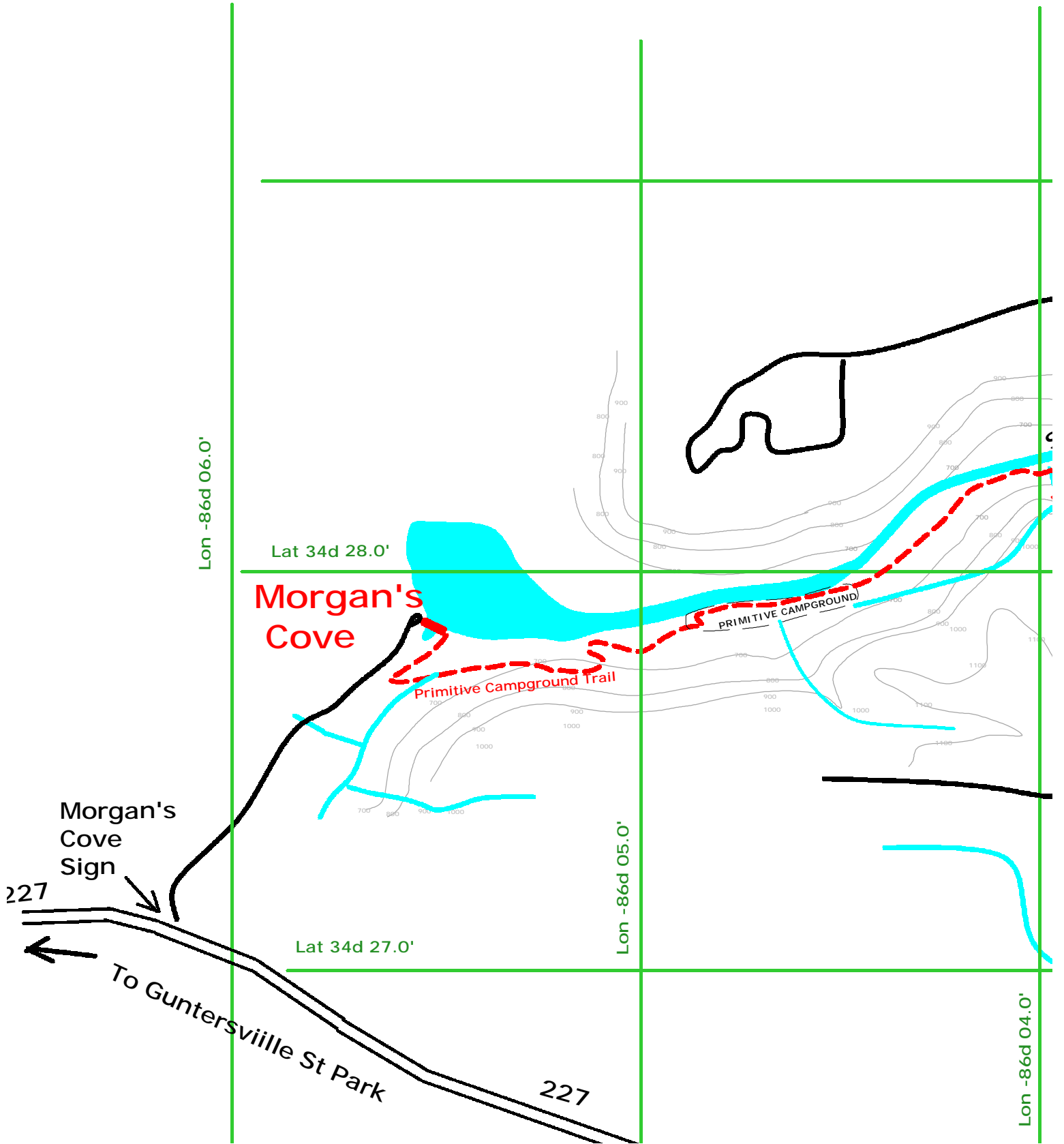

Lon -86d 06.0'

Lat 34d 28.0'

Morgan's Cove

Primitive Campground Trail

PRIMITIVE CAMPGROUND

Morgan's Cove Sign

227

To Guntersville St Park

227

Lon -86d 05.0'

Lat 34d 27.0'

Lon -86d 04.0'

